



Building and Safety Division - Public Information

County of Ventura • Resource Management Agency • http://www.ventura.org/rma/build_safe
 Main Office • 800 S. Victoria Ave, Ventura, CA. 93009 • 805-654-2771
 East County Office • 3855-F Alamo St., 2nd Fl. # 2019A, Simi Valley, CA 93065 • 805-582-8064

DETACHED RETAINING WALL - LEVEL GRADE

BUILDING PERMIT REQUIRED

FOR H= 3' OR LESS, BUILDING PERMIT IS NOT REQUIRED

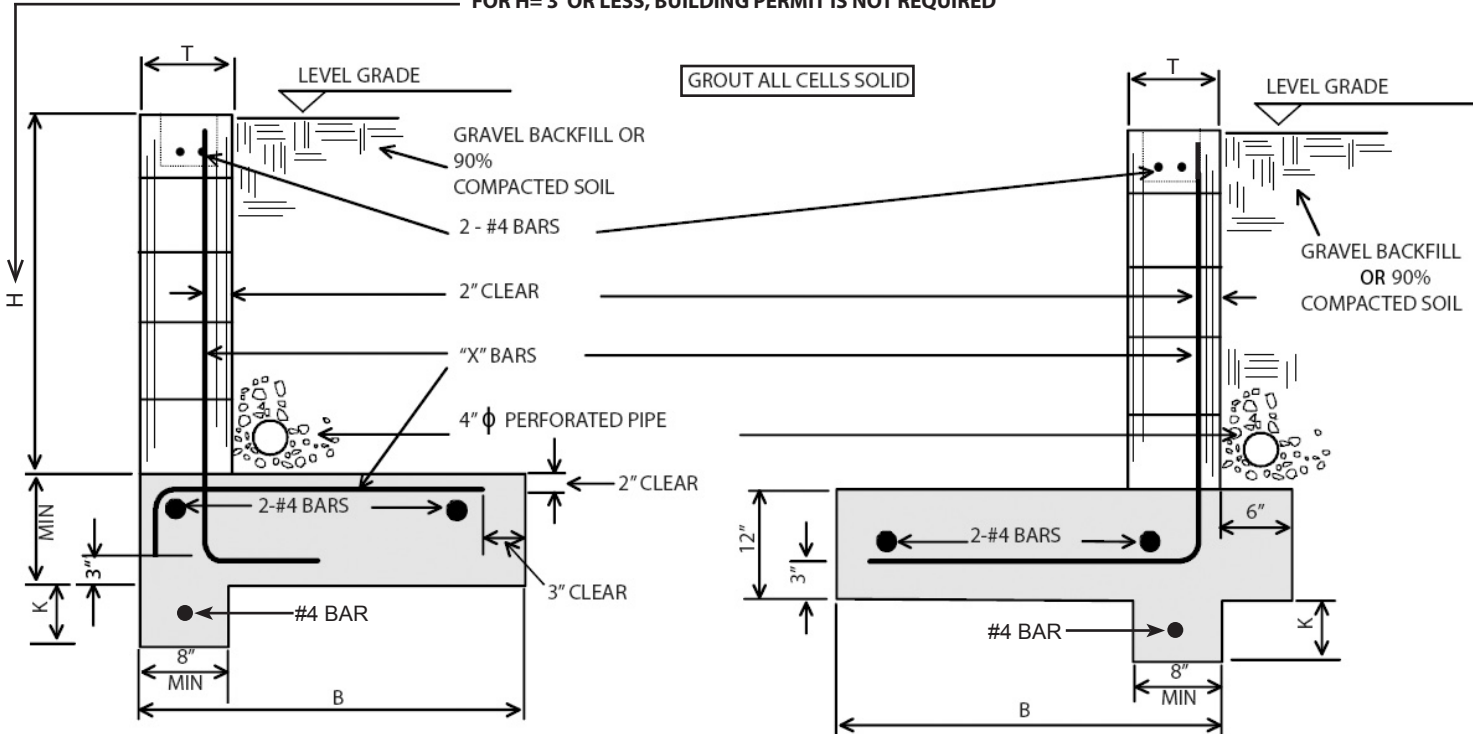

H	B	T	"X" BARS	K
2'- 0"	1'- 6"	6"	#3 @ 48" O.C.	6"
3'- 0"	2'- 0"	6"	#3 @ 24" O.C.	8"
4'- 0"	3'- 0"	8"	#4 @ 24" O.C.	12"

General Notes:

- Concrete - 2500 p.s.i. Min. @ 28 days.
- Reinf. Steel - Grade 40. $f_s=20,000$ p.s.i.
- Reinf. Steel Laps - Min. 1'-8".
- Concrete Masonry Units with type "M" mortar $f'm=1500$ p.s.i.
- Grout - 1 part cement (plastic cement not permitted) maximum one tenth of hydrated lime or lime putty, $2\frac{1}{4}$ to 3 parts sand, 2 parts pea gravel.
- Mortar type "M" or "S" - 1 part cement, $\frac{1}{4}$ part hydrated lime or lime putty, sand $2\frac{1}{4}$ - 3 times the sum of cement and lime.
- Soil - Minimum. 1000 p.s.f. bearing pressure.
- Backfill - sand or gravel soil.
- All workmanship and materials to conform with the CALIFORNIA BUILDING CODE.
- No surcharge on wall. Consult a professional Civil or Structural Engineer for design of retaining wall having:
 - a height greater than 4 feet and/or
 - any surcharge. (Vehicle loading, adjacent footings, etc.)
- Compaction report is not required for the backfill behind the wall only.

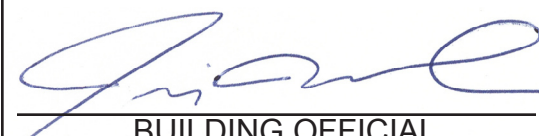
 BUILDING OFFICIAL

STD. B-12
 SHEET 1 OF 2
 JAN. 2008

REVISED OCT.2008



Building and Safety Division - Public Information

County of Ventura • Resource Management Agency • http://www.ventura.org/rma/build_safe
Main Office • 800 S. Victoria Ave, Ventura, CA. 93009 • 805-654-2771
East County Office • 3855-F Alamo St., 2nd Fl. # 2019A, Simi Valley, CA 93065 • 805-582-8064

FENCE WITH RETAINING WALL Building Permit Required

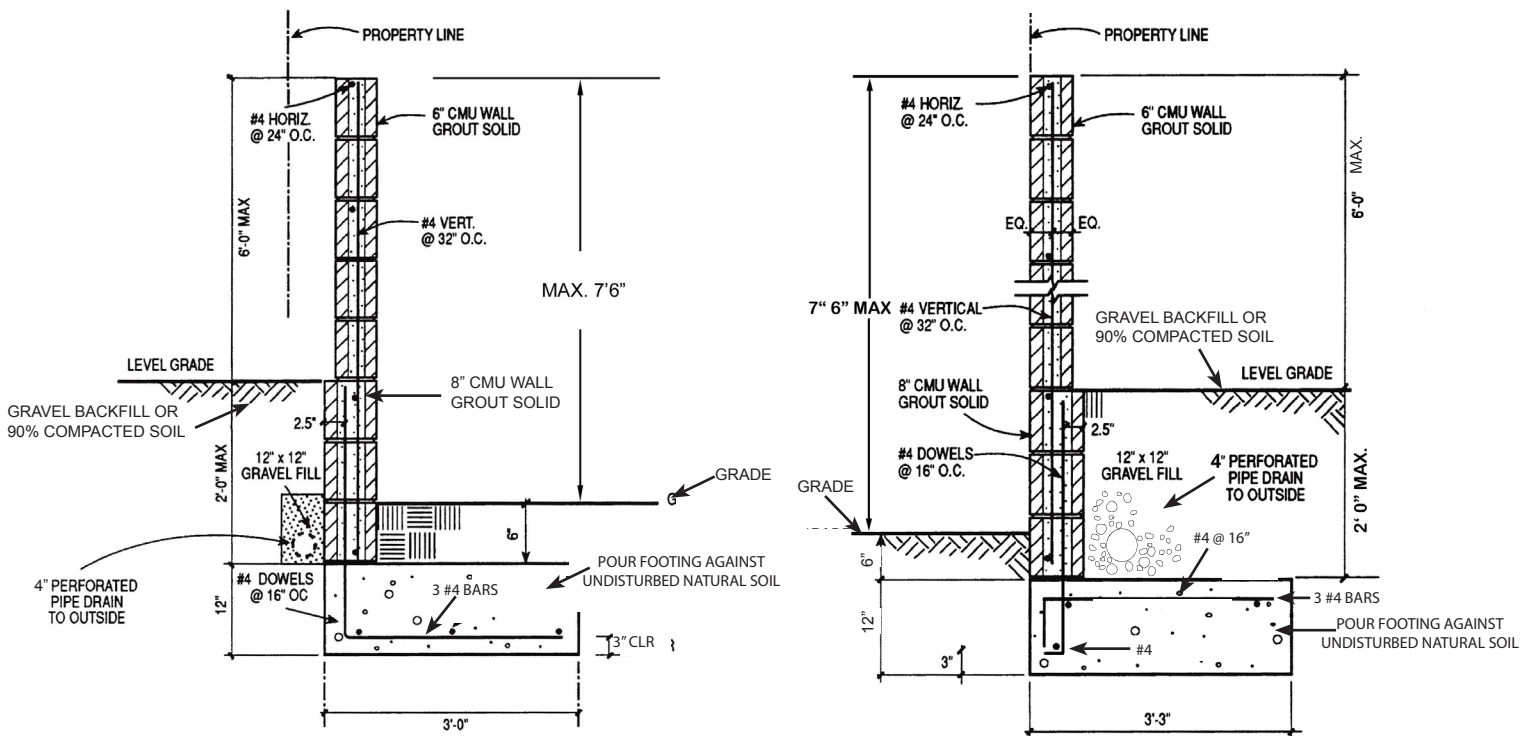

General Notes:

1. Concrete - 2500 p.s.i. Min. @ 28 days.
2. Reinf. Steel - Grade 40. $f_s=20,000$ p.s.i.
3. Reinf. Steel Laps - Min. 1'-8".
4. Concrete Masonry Units with type "M" mortar $f'm=1500$ p.s.i.
5. Grout - 1 part cement (plastic cement not permitted) maximum one tenth of hydrated lime or lime putty, $2\frac{1}{4}$ to 3 parts sand, 2 parts pea gravel.
6. Mortar type "M" or "S" - 1 part cement, $\frac{1}{4}$ part hydrated lime or lime putty, sand $2\frac{1}{4}$ - 3 times the sum of cement and lime.
7. Soil - MINIMUM 1000 p.s.f. bearing pressure.
8. Backfill - sand or gravel soil.
9. All workmanship and materials to conform with the CALIFORNIA BUILDING CODE.
10. No surcharge on wall. Consult a professional Civil or Structural Engineer for design of retaining wall having:
 - a) a height greater than 2 feet and/or
 - b) any surcharge. (Vehicle loading, adjacent footings, etc.)
11. Compaction report is not required for the backfill behind the wall only.

	STD. B-12 SHEET 2 OF 2
BUILDING OFFICIAL	JAN. 2008

REVISED OCT.2008